

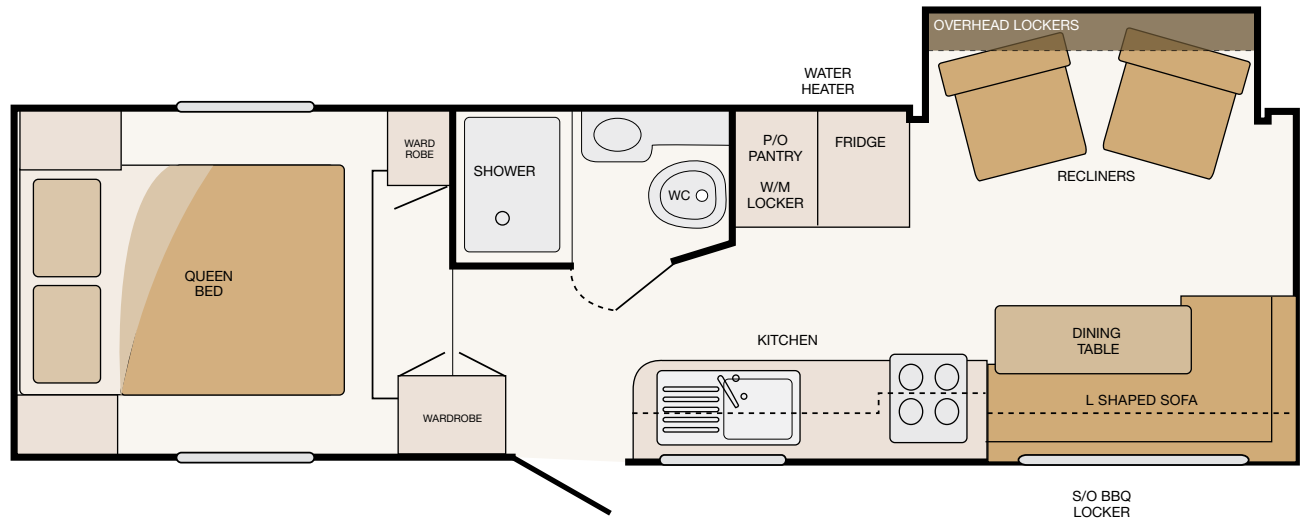

CUT LOOSE 'PANDORA' (8.0M)



www.cutlooserv.com.au



FREEDOM LUXURY SAFETY VALUE PEACE-OF-MIND MODERN FLEXIBILITY



COMPACT FIFTH WHEELER WITH ALL THE ACCESSORIES

The 'Pandora RL' is the flagship model in the Cut Loose range. It is an 8 metre masterpiece hosting luxurious recliners in a slide-out living area surrounded by large panoramic windows. Contemporary vogue interiors and the aerodynamic external design make this RV the most stylish on the road. The spacious design includes a large slide-out, abundant cupboards, pull-out pantries and external lockers which allows a maximum comfort lifestyle in the home away from home.

STANDARD FEATURES

DESIGN AND BUILD

- Unique aerodynamic fibreglass nose cone
- Laminated aluminium frame construction
- Full insulation in walls, flooring and roof
- Superior Hi Gloss Lamilux fibreglass finish
- Powder coated 6 inch steel chassis
- High strength Gooseneck
- Australian compliant Kingpin
- Walk on truss roof with UV resistant membrane
- Equa-flex road friendly suspension
- Hopper style windows with tinted safety glass
- 15 inch wheels with quality Goodyear tyres
- Flush floor slide-out
- Handbrake
- Large entrance door

ELECTRICAL

- Full Australian installation of 240 volt system with rcd protection and circuit breakers
- 240 volt inlet and up to 10 no. outlet sockets
- Dometic 3.2KW ducted air-con system with heating & thermostatic wall controls
- 150Ah AGM deep cycle maint. free battery
- Battery 12 volt isolation switch
- Battery low voltage protection
- Xantrex Truecharge 2 Smart battery charger
- LED road lights ADR approved
- Low energy interior lighting throughout with LED reading lights
- Digital Voltmeter
- Master and wall mounted lighting switches
- Tank and battery monitors
- Wiring solar ready
- Only Australian appliances fitted
- Full Certification to AS 3001

GAS & HEATING

- Entire gas system designed & built in Australia
- Full Certification to AS5601
- Suburban 23L water heater—gas & 240 volt
- 2 x 9kg gas bottles

EXTERNAL FEATURES

- Exterior hot and cold beach shower
- 17ft (5.2m) awning (8500 series) with patio light & TV outlet
- Awning cradle and centre rafter
- Electric jacks (with manual facility) fitted with snap-locks
- Generous front storage locker (under gooseneck)
- Additional external locker LHS (front)

INTERNAL FEATURES

General

- New Birch or Maple cabinetry with solid timber doors
- New satin cabinetry hardware
- New contemporary interior design in 2 fabric options
- Elegant day/night blinds with stylish pelmets

Bathroom

- Full flush Dometic toilet
- One piece fibre glass shower cubicle with quality satin mixer & rollaway shower door
- Large vanity unit with satin mixer tap
- Bathroom power ventilation (12 volt)
- Quality chrome bathroom fittings

Kitchen

- Quality stone effect composite benchtop
- Full width drawer pack
- Large pull-out pantries
- Large stainless steel single sink & drainer with chrome mixer tap
- Dometic 3 gas 1 electric cooktop with grill
- Slimline Stainless steel range hood
- Water filter with chrome faucet
- Panasonic 23L stainless steel microwave (or equiv)
- Waeco 190L 12 volt fridge/freezer (or equiv)
- Range of overhead and under-bench cupboards

Bedroom

- Queen bed with quality innerspring mattress
- Large 50cm Fiamma roof vent with roller blind
- Under bed storage with gas struts
- Bedside cabinets with LED reading light & electric sockets

- 2 large full height wardrobes
- TV point and double power point
- Bedspread, cushions and Privacy curtain

Lounge/Dining

- Flush floor lounge slide-out with overhead lockers
- 2 luxurious wall hugger recliners
- L shaped lounge which converts to a bed
- Free-standing table
- 2 large pan drawers under lounge
- Wineguard TV antennae with built in booster
- 3 large windows to let the great outdoors in
- Sony CD radio with MP3 facility (or equiv)

Safety & Security

- Full Trailer ADR certification
- Electric brakes to all wheels with safety break-away feature
- A,B,E fire extinguisher
- Safety glass to all windows
- Smoke, CO & LPG detectors
- Deadbolt lock to entrance door
- Also includes—Supply of Hijacker double pivot hitch (ADR compliant)

OPTIONAL FEATURES

For a comprehensive list of options please refer to the Cut Loose Options & Accessories sheet. We can provide you with a custom price for your fit-out.

SPECIFICATIONS (approx)

Weights	ATM	3592kg
	Tare mass (standard fit-out)	2900kg
	Hitch transfer weight	400kg
Dimensions	Length internal wall to wall	7.96m
	Pin-box to spare wheel	8.68m
	Width external wall to wall	2.30m
	Internal height	2.03m
	External height	2.89m
To top of air-con unit	3.24m	
Capacities	Fresh water	165L
	Grey water	105L
	Galley tank	125L
	Black water	125L



Cut Loose RV Pty Ltd
 Unit 1, 14 Dover Drive,
 Burleigh Heads Q. 4220
 Telephone 07 5520 7575
 Mobile 0432 096 777
 escape@cutlooserv.com.au
 www.cutlooserv.com.au